

Hydraulic Box Dumper

ENDURA
-VEYOR
INC.

**Lifts Gaylord
Boxes, Carts and
Other Containers**

Increases Productivity

**Eliminates Injuries from
Bending & Lifting**

**Stainless Options
Available**

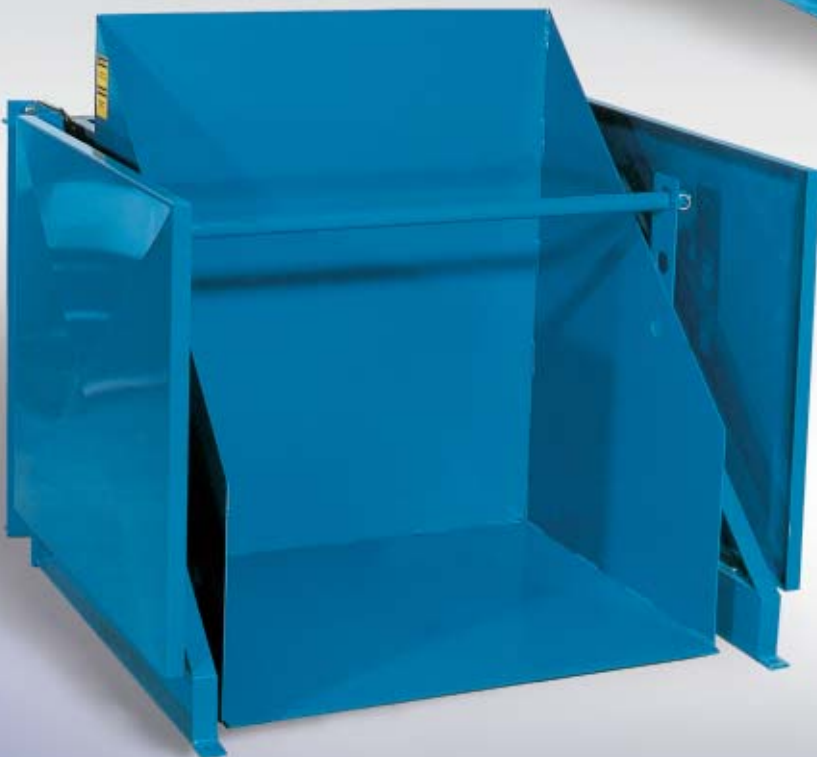

18 Standard Models
to Choose From — or
Let Us Custom-Engineer
a Model for You!

Hydraulic Box Dumper

STANDARD SPECIFICATIONS

Lifting Capacity: 2,000, 4,000 and 6,000 lbs.

Dump Height: 36 in., 48 in. and 60 in.

Motor: 2 hp TEFC, 230/460V, three phase with overload protection.

Controls: 2 button pendant with 15 ft. cord.

Dump Angle: 45 degrees.

Hydraulics: Self contained hydraulic power unity with integral valving, including relief valve, check valve, down solenoid valve and flow control valve to regulate speed of descent.

Frame Construction: Heavy-duty reinforced structural steel with bolt-on safety side panels.

Drum Construction: Reinforced welded 7 gauge steel.

Drum Size: 52 in. wide x 48 in. deep or 40 in. wide x 36 in. deep with adjustable retaining bar for containers from 24 in. to 48 in. high.

Paint: One coat of primer and Endura-Veyor blue.

OPTIONS

115/230 volt single phase (with no change in lift time).

Double acting hydraulic cylinders.

Velocity fuse (in case of a hose rupture).

Limit switches to control up/down cycle.

Custom engineering for your specific need.

Custom paint.

Stainless steel construction.

Dumper stands for increased dump height.

Enclosed fence with interlock gate (allows dumper to operate only when gate is closed).

Ordering Information

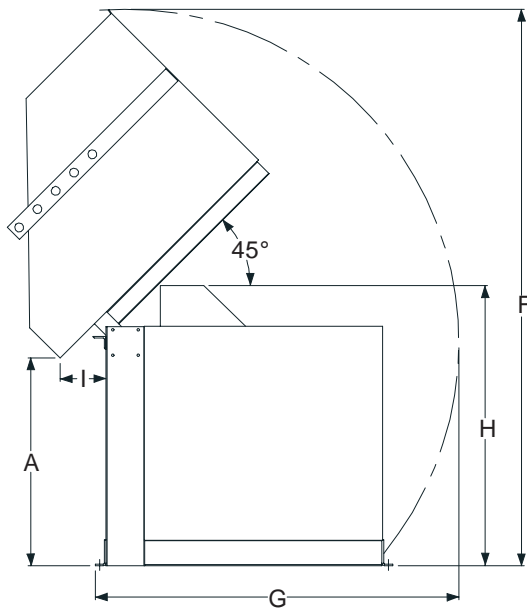
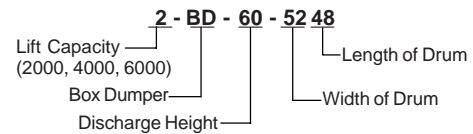

SIDE VIEW

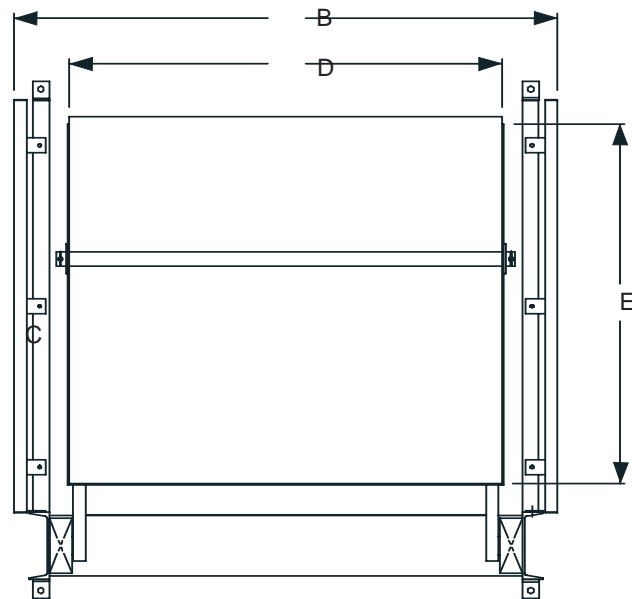

TOP VIEW

Dimension Chart: 2,000 Pound Lift

Model Number	Dump Height (A)	Overall Dimensions (B x C)	Drum Dimensions (D x E)	Arc Height (F)	Arc Width (G)	Drum Height (H)	Reach (I)	Motor (HP)	Lift Time (Sec.)	Shipping Weight (lbs.)
2BD-36-4036	36	53 1/4 x 57	40 x 36	100	67 3/8	53	10 5/8	2	20	1185
2BD-36-5248	36	65 1/4 x 69	52 x 48	109 9/16	76 13/16	53	10 5/8	2	20	1475
2BD-48-4036	48	53 1/4 x 57	40 x 36	120 1/2	75 7/8	65	10 5/8	2	27	1400
2BD-48-5248	48	65 1/4 x 69	52 x 48	129	84 5/16	65	10 5/8	2	27	1675
2BD-60-4036	60	53 1/4 x 57	40 x 36	141	85 3/8	77	10 5/8	2	33	1630
2BD-60-5248	60	65 1/4 x 69	52 x 48	149 7/16	92 7/8	77	10 5/8	2	33	1980

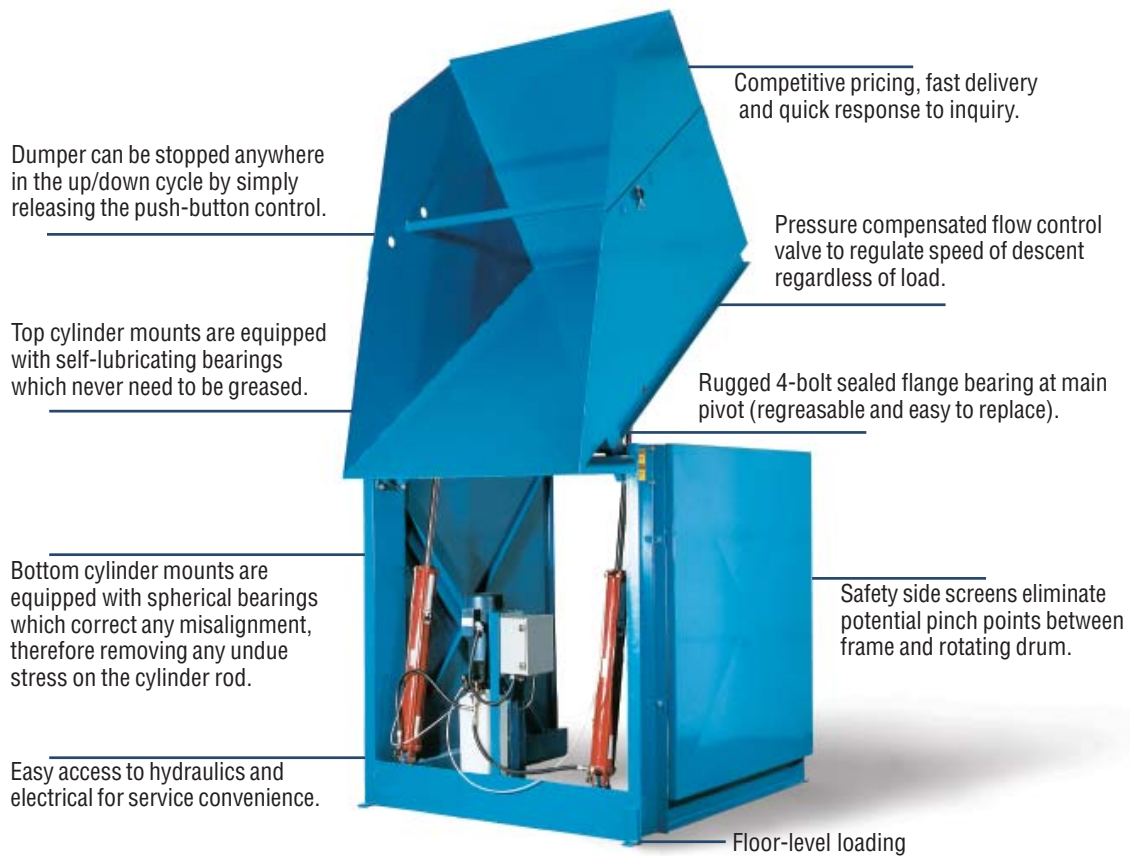

Dimension Chart: 4,000 Pound Lift										
Model Number	Dump Height (A)	Overall Dimensions (B x C)	Drum Dimensions (D x E)	Arc Height (F)	Arc Width (G)	Drum Height (H)	Reach (I)	Motor (HP)	Lift Time (Sec.)	Shipping Weight (lbs.)
4BD-36-4036	36	53 1/4 x 57	40 x 36	100	67 3/8	53	10 5/8	2	29	1200
4BD-36-5248	36	65 1/4 x 69	52 x 48	109 9/16	76 13/16	53	10 5/8	2	29	1495
4BD-48-4036	48	53 1/4 x 57	40 x 36	120 1/2	75 7/8	65	10 5/8	2	38	1420
4BD-48-5248	48	65 1/4 x 69	52 x 48	129	84 5/16	65	10 5/8	2	38	1690
4BD-60-4036	60	53 1/4 x 57	40 x 36	141	85 3/8	77	10 5/8	2	48	1650
4BD-60-5248	60	65 1/4 x 69	52 x 48	149 7/16	92 7/8	77	10 5/8	2	48	2000

Dimension Chart: 6,000 Pound Lift										
Model Number	Dump Height (A)	Overall Dimensions (B x C)	Drum Dimensions (D x E)	Arc Height (F)	Arc Width (G)	Drum Height (H)	Reach (I)	Motor (HP)	Lift Time (Sec.)	Shipping Weight (lbs.)
6BD-36-4036	36	53 1/4 x 57	40 x 36	100	67 3/8	53	10 5/8	2	36	1210
6BD-36-5248	36	65 1/4 x 69	52 x 48	109 9/16	76 13/16	53	10 5/8	2	36	1505
6BD-48-4036	48	53 1/4 x 57	40 x 36	120 1/2	75 7/8	65	10 5/8	2	48	1430
6BD-48-5248	48	65 1/4 x 69	52 x 48	129	84 5/16	65	10 5/8	2	48	1700
6BD-60-4036	60	53 1/4 x 57	40 x 36	141	85 3/8	77	10 5/8	2	60	1660
6BD-60-5248	60	65 1/4 x 69	52 x 48	149 7/16	92 7/8	77	10 5/8	2	60	2010

Hydraulic Box Dumper Worksheet

Customer _____ Contact _____
 _____ Phone # _____
 _____ Date ____ / ____ / ____ P.O.# _____
 Quote # _____ Job # _____
 Delivery _____ Salesperson _____

Capacity: 2000 # _____ 4000 # _____ 6000 # _____

Dumping height required: _____

Customer container size and description: _____

Overhead operating clearance: _____

Method of loading: _____

Material to be dumped: _____

Food _____ Liquid _____ Solid _____ Dusty _____ Free-flowing _____ Sticky _____

Atmosphere/environment: Wet _____ Dry _____ Corrosive _____ Outdoors _____ Indoors _____

Power supply: Single-Phase _____ Three-Phase _____

Duty cycle: Per hour _____ Hours per day _____ Days per week _____

Other special modifications: _____

Price: _____ **Delivery:** _____

NOTE: Container Dumpers must be lagged to the floor.

Endura-Veyor Products:



- Hinged Steel Belt & Chip Conveyors
- Medium Duty Slider Bed Conveyors
- Light Duty Slider Bed & Parts Handling Conveyors
- Container Dumpers
- Boxwall Conveyors
- Low Profile Slider Bed Conveyors

Light Duty Slider Bed & Parts Conveyors:



- Feeding Grinders
- Injection Molding Feed & Exit Conveyors
- Transfer Conveyors
- Low Profile Stamping Industry Conveyors

Chain Driven Steel Belt Conveyors:



- Scrap Metal
- Metal Chip Handling
- Parts Handling
- Metal Stamping
- Tool & Die Industry
- Press & Exit Feeders
- Automotive Industry
- Transfer Crated or Baled Materials
- Temperatures (Parts up to 800°)
- Crushed Glass, Metals etc.
- Baler, Compactor or Shredder Feed
- Recycling Industry

Medium Duty Slider Bed Conveyors:



- Recycling Industry
- Sorting Stations
- Baler, Compactor or Shredder Feed
- Automotive Industry
- Trash Handling
- Transfer Baled Materials

